

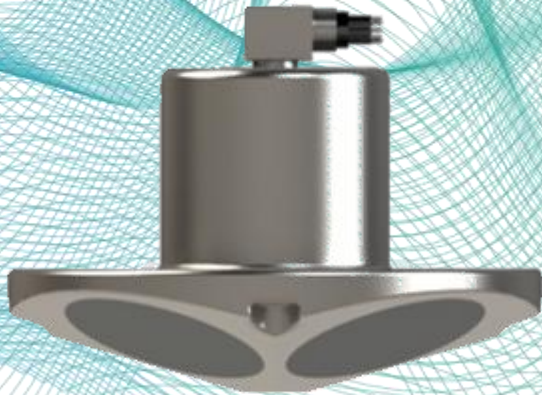

china sonar

CHINA SONAR Product Brochure



ADCP

Acoustic Doppler Current Profiler

China Sonar (Hangzhou) Technology Co., Ltd.

Series ADCP Instruments

ADCP Instrument Series



● PandaADCP-DR-600K Series	-----04
● PandaADCP-DR-300K Series	-----05
● PandaADCP-DR-75K Series	-----06
● PandaADCP-DR-75K Phased Series	-----07
● PandaADCP-SC-600K Series	-----08
● PandaADCP-SC-300K Series	-----09
● PandaADCP-SC-75K Series	-----10
● PandaADCP-SC-75K Phased Series	-----11
● PandaADCP-RM-600K(H-ADCP) Series	-----12

Product Highlights

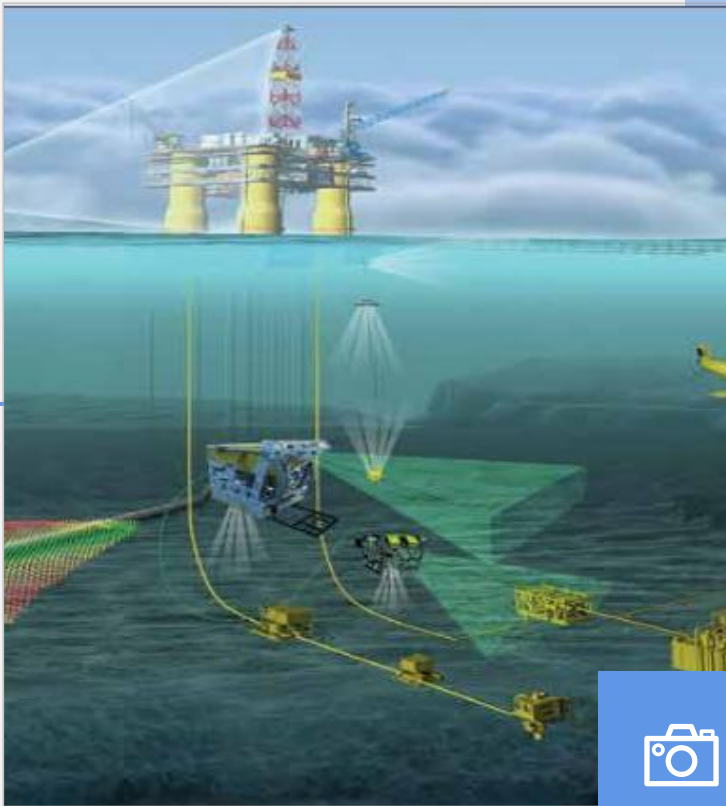

- **More Reliable Material**

All series are standardly equipped with titanium alloy.

- **Substitute For Similar Products**

benchmarked against the industry's top ADCP products and can be directly substituted.

- **High Precision, High Reliability**

The precision is comparable to that of industry-leading products.
The continuous working time is not less than 180 days.

- **Small Size**

The size is much smaller than that of similar products with the same performance in the industry.

- **Small Blind Area**

applied to various suddenly changing underwater environments.

- **Strong Compatibility**

Compatible with the communication protocol of similar products.

- **Convenient Operation**

It can work when powered on/ can work automatically in set mode.

- **High Cost Performance**

The product is inexpensive and easy to use.

- **Water Profile, Bottom Track and Water Track included**

Standard in all models, no additional payment is required.

PandaADCP-DR-600K Series

Acoustical property

Working Frequency: 600kHz
 Bottom Track Range: 110m
 Beam Configuration: 4-beams,convex
 Beam Angle: 20°
 Beam width: 3.5°
 Ping Rate: 2Hz(typical)
 Number of Depth Cells: 1-255
 Velocity Accuracy: $\pm 0.3\% \pm 3\text{mm/s}$
 Velocity Resolution: 1mm/s
 Velocity Range: $\pm 5.0 \text{ m/s}$ (Default); $\pm 20.0 \text{ m/s}$ (Maximum)
 Depth Cell Dimensions(High Pricision Mode): 0.5m /1m /2m /4m
 Water Profiling Range (Broadband / Narrowband): 55m/70m

Interface Chracteristics

Communications: RS-232 or RS-422
 Power Input: 20V~50V
 Power Comsumption: $\leq 10\text{W}$
 Internal Memory: 64 GB Micro SD Card
 Sensors: Water Temperature, Pressure, Compass,Tilt

PandaADCP-DR-600K-1000m
External Dimensions

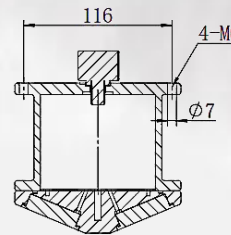

PandaADCP-DR-600K-3000m
External Dimensions

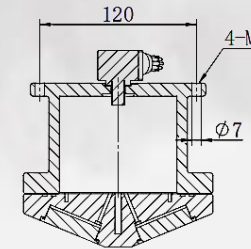

PandaADCP-DR-600K-6000m
External Dimensions

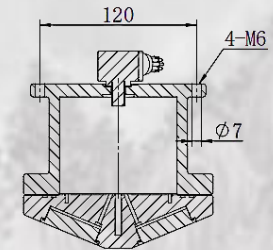

PandaADCP-DR-600K-200m/1000m

Physical property

Casing: Titanium alloy
 Standard depth rating: 200m/1000m
 Weight in air: 1.8kg
 Weight in water: 1.1kg
 Dimensions: $\Phi 130\text{mm} \times 117\text{mm}$ (Exclude top connector)
 Dimensions: $\Phi 130\text{mm} \times 142\text{mm}$ (Includes top connector)



PandaADCP-DR-600K-3000m

Physical property

Casing: Titanium alloy
 Standard depth rating: 3000m
 Weight in air: 3.8kg
 Weight in water: 3.0kg
 Dimensions: $\Phi 145\text{mm} \times 126\text{mm}$ (Exclude top connector)
 Dimensions: $\Phi 145\text{mm} \times 151\text{mm}$ (Includes top connector)



PandaADCP-DR-600K-6000m

Physical property

Casing: Titanium alloy
 Standard depth rating: 6000m
 Weight in air: 4.6kg
 Weight in water: 4.0kg
 Dimensions: $\Phi 145\text{mm} \times 136\text{mm}$ (Exclude top connector)
 Dimensions: $\Phi 145\text{mm} \times 161\text{mm}$ (Includes top connector)



PandaADCP-DR-300K Series

Acoustical property

Working Frequency: 300kHz
Bottom Track Range: 220m
Beam Configuration: 4-beams,convex
Beam angle: 20°
Beam width: 3.5°
Ping Rate: 2Hz(typical)
Number of Depth Cells: 1-255
Velocity Accuracy: $\pm 0.5\% \pm 5\text{mm/s}$
Velocity Resolution: 1mm/s
Velocity Range: $\pm 5.0\text{ m/s}$ (Default); $\pm 20.0\text{ m/s}$ (Maximum)
Depth Cell Dimensions(High Pricision Mode): 0.5m /1m /2m /4m /8m
Water Profiling Range (Broadband / Narrowband): 120m/160m

Interface Characteristics

Communications: RS-232 or RS-422
Power Input: 20V~50V
Power Comsumption: $\leq 10\text{W}$
Internal Memory: 64 GB Micro SD Card
Sensors: Water Temperature, Pressure, Compass,Tilt

PandaADCP-DR-300K Series External Dimensions

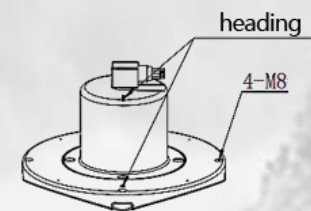
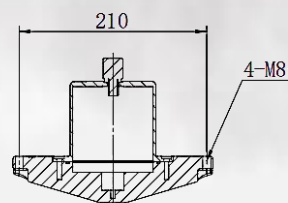

PandaADCP-DR-300K-200m/1000m

Physical property

Casing: Titanium alloy
Standard depth rating: 200m/1000m
Weight in air: 3.8kg
Weight in water: 2.9kg
Dimensions: $\Phi 224\text{mm} \times 135\text{mm}$ (Exclude top connector)
Dimensions: $\Phi 224\text{mm} \times 160\text{mm}$ (Includes top connector)

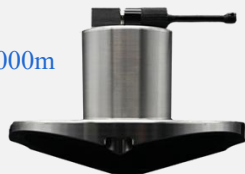

PandaADCP-DR-300K-3000m

Physical property

Casing: Titanium alloy
Standard depth rating: 3000m
Weight in air: 7.2kg
Weight in water: 5.7kg
Dimensions: $\Phi 230\text{mm} \times 135\text{mm}$ (Exclude top connector)
Dimensions: $\Phi 230\text{mm} \times 160\text{mm}$ (Includes top connector)



PandaADCP-DR-300K-6000m

Physical property

Casing: Titanium alloy
Standard depth rating: 6000m
Weight in air: 8.4kg
Weight in water: 7.4kg
Dimensions: $\Phi 230\text{mm} \times 140\text{mm}$ (Exclude top connector)
Dimensions: $\Phi 230\text{mm} \times 165\text{mm}$ (Includes top connector)



PandaADCP-DR-75K Series

Acoustical property

Working Frequency: 75kHz
 Bottom Track Range: 1000m
 Beam Configuration: 4-beams,convex
 Beam angle: 20°
 Beam width: 4°
 Ping Rate: 1Hz(typical)
 Number of Depth Cells: 1-255
 Velocity Accuracy: $\pm 1.0\% \pm 5\text{mm/s}$
 Velocity Resolution: 1mm/s
 Velocity Range: $\pm 5.0 \text{ m/s}$ (Default); $\pm 20.0 \text{ m/s}$ (Maximum)
 Depth Cell Dimensions(High Pricision Mode): 4m /8m /16m/32m
 Water Profiling Range (Broadband / Narrowband): 550m/650m

Interface Chraacteristics

Communications: RS-232 or RS-422
 Power Input: 20V~50V
 Power Comsumption: $\leq 20\text{W}$
 Internal Memory: 64 GB Micro SD Card
 Sensors: Water Temperature, Pressure, Compass,Tilt

PandaADCP-DR-75K-500m

Physical property

Casing: POM
 Standard depth rating: 500m
 Weight in air: 65kg
 Weight in water: 30kg
 Dimensions: $\Phi 600\text{mm} \times 180\text{mm}$ (Includes top connector)

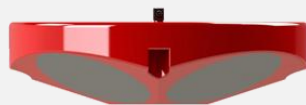

PandaADCP-DR-75K Series External Dimensions

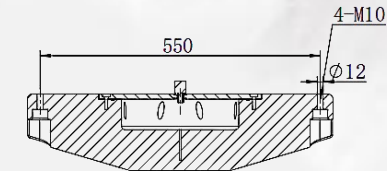
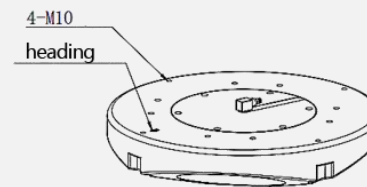

PandaADCP-DR-75K-Phased Series

Acoustical property

Working Frequency: 75kHz
 Bottom Track Range: 1000m
 Beam Configuration: 4-beams, Phased
 Beam angle: 30°
 Beam width: 4°
 Ping Rate: 1Hz(typical)
 Number of Depth Cells: 1-255
 Velocity Accuracy: $\pm 1.0\% \pm 5\text{mm/s}$
 Velocity Resolution: 1mm/s
 Velocity Range: $\pm 5.0\text{ m/s}$ (Default); $\pm 20.0\text{ m/s}$ (Maximum)
 Depth Cell Dimensions(High Precision Mode): 4m /8m /16m/32m
 Water Profiling Range (Broadband / Narrowband): 550m/650m

Interface Characteristics

Communications: RS-232 or RS-422
 Power Input: 20V~50V
 Power Consumption: $\leq 20\text{W}$
 Internal Memory: 64 GB Micro SD Card
 Sensors: Water Temperature, Pressure, Compass, Tilt

PandaADCP-DR-75K-1000m

Physical property

Casing: Titanium alloy
 Standard depth rating: 1000m
 Weight in air: 52kg
 Weight in water: 34kg
 Dimensions: $\Phi 350\text{mm} \times 219\text{mm}$ (Includes top connector)



PandaADCP-DR-75K-3000m

Physical property

Casing: Titanium alloy
 Standard depth rating: 3000m
 Weight in air: 58kg
 Weight in water: 38kg
 Dimensions: $\Phi 360\text{mm} \times 229\text{mm}$ (Includes top connector)



PandaADCP-DR-75K-6000m

Physical property

Casing: Titanium alloy
 Standard depth rating: 6000m
 Weight in air: 65kg
 Weight in water: 47kg
 Dimensions: $\Phi 370\text{mm} \times 244\text{mm}$ (Includes top connector)



PandaADCP-SC-600K Series

Acoustical property

Working Frequency: 600kHz
 Bottom Track Range: 110m
 Beam Configuration: 4-beams,convex
 Beam angle: 20°
 Beam width: 3.5°
 Ping Rate: 2Hz(typical)
 Number of Depth Cells: 1-255
 Velocity Accuracy: $\pm 0.3\% \pm 3\text{mm/s}$
 Velocity Resolution: 1mm/s
 Velocity Range: $\pm 5.0\text{ m/s}$ (Default); $\pm 20.0\text{ m/s}$ (Maximum)
 Depth Cell Dimensions(High Pricision Mode): 0.5m /1m /2m /4m
 Water Profiling Range (Broadband / Narrowband): 55m/70m

Interface Chracteristics

Batteries: Lithium Battery(504 walt hour)
 Communications: RS-232 or RS-422
 Power Input: 20V~50V
 Power Comsumption: $\leq 10\text{W}$
 Internal Memory: 64 GB Micro SD Card
 Sensors: Water Temperature, Pressure, Compass,Tilt

PandaADCP-SC-600K-200m/1000m

Physical property

Casing: Titanium alloy
 Standard depth rating: 200m/1000m
 Weight in air: 2.7kg
 Weight in water: 1.1kg
 Dimensions: $\Phi 130\text{mm} \times 327\text{mm}$



PandaADCP-SC-600K-3000m

Physical property

Casing: Titanium alloy
 Standard depth rating: 3000m
 Weight in air: 4.5kg
 Weight in water: 2.9kg
 Dimensions: $\Phi 145\text{mm} \times 339\text{mm}$



PandaADCP-SC-600K-6000m

Physical property

Casing: Titanium alloy
 Standard depth rating: 6000m
 Weight in air: 7.0kg
 Weight in water: 5.4kg
 Dimensions: $\Phi 145\text{mm} \times 351\text{mm}$



PandaADCP-SC-300K Series

Acoustical property

Working Frequency: 300kHz
 Bottom Track Range: 220m
 Beam Configuration: 4-beams,convex
 Beam angle: 20°
 Beam width: 3.5°
 Ping Rate: 2Hz(typical)
 Number of Depth Cells: 1-255
 Velocity Accuracy: $\pm 0.5\% \pm 5\text{mm/s}$
 Velocity Resolution: 1mm/s
 Velocity Range: $\pm 5.0\text{ m/s}$ (Default); $\pm 20.0\text{ m/s}$ (Maximum)
 Depth Cell Dimensions(High Precision Mode): 0.5m /1m /2m /4m /8m
 Water Profiling Range (Broadband / Narrowband): 120m/160m

Interface Characteristics

Batteries: Lithium Battery(1008 walt hour)
 Communications: RS-232 or RS-422
 Power Input: 20V~50V
 Power Comsumption: $\leq 10\text{W}$
 Internal Memory: 64 GB Micro SD Card
 Sensors: Water Temperature, Pressure, Compass,Tilt

PandaADCP-SC-300K-200m/1000m

Physical property

Casing: Titanium alloy
 Standard depth rating: 200m/1000m
 Weight in air: 8kg
 Weight in water: 4kg
 Dimensions: $\Phi 224\text{mm} \times 285\text{mm}$



PandaADCP-SC-300K-3000m

Physical property

Casing: Titanium alloy
 Standard depth rating: 3000m
 Weight in air: 11.5kg
 Weight in water: 7.5kg
 Dimensions: $\Phi 230\text{mm} \times 300\text{mm}$



PandaADCP-SC-300K-6000m

Physical property

Casing: Titanium alloy
 Standard depth rating: 6000m
 Weight in air: 15.5kg
 Weight in water: 11.5kg
 Dimensions: $\Phi 230\text{mm} \times 315\text{mm}$



PandaADCP-SC-75K Series

Acoustical property

Working Frequency: 75kHz
Bottom Track Range: 1000m
Beam Configuration: 4-beams,convex
Beam angle: 20°
Beam width: 4°
Ping Rate: 1Hz(typical)
Number of Depth Cells: 1-255
Velocity Accuracy: $\pm 1.0\% \pm 5\text{mm/s}$
Velocity Resolution: 1mm/s
Velocity Range: $\pm 5.0\text{ m/s}$ (Default); $\pm 20.0\text{ m/s}$ (Maximum)
Depth Cell Dimensions(High Pricision Mode): 4m /8m /16m/32m
Water Profiling Range (Broadband / Narrowband): 550m/650m

Interface Chracteristics

Batteries: Lithium Battery(2300 walt hour)
Communications: RS-232 or RS-422
Power Input: 20V~50V
Power Comsumption: $\leq 20\text{W}$
Internal Memory: 64 GB Micro SD Card
Sensors: Water Temperature, Pressure, Compass,Tilt

PandaADCP-DR-75K-500m

Physical property

Casing: POM
Standard depth rating: 500m
Weight in air: 62kg
Weight in water: 42kg
Dimensions: $\Phi 600\text{mm} \times 300\text{mm}$ (Includes top connector)



PandaADCP-SC-75K-Phased Series

Acoustical property

Working Frequency: 75kHz
 Bottom Track Range: 1000m
 Beam Configuration: 4-beams, Phased
 Beam angle: 30°
 Beam width: 4°
 Ping Rate: 1Hz(typical)
 Number of Depth Cells: 1-255
 Velocity Accuracy: $\pm 1.0\% \pm 5\text{mm/s}$
 Velocity Resolution: 1mm/s
 Velocity Range: $\pm 5.0\text{ m/s}$ (Default); $\pm 20.0\text{ m/s}$ (Maximum)
 Depth Cell Dimensions(High Precision Mode): 4m /8m /16m/32m
 Water Profiling Range (Broadband / Narrowband): 550m/650m

Interface Characteristics

Batteries: Lithium Battery(2300)
 Communications: RS-232 or RS-422
 Power Input: 20V~50V
 Power Consumption: $\leq 20\text{W}$
 Internal Memory: 64 GB Micro SD Card
 Sensors: Water Temperature, Pressure, Compass, Tilt

PandaADCP-SC-75K-Phased-1000m

Physical property

Casing: Titanium alloy
 Standard depth rating: 1000m
 Weight in air: 55kg
 Weight in water: 37kg
 Dimensions: $\Phi 348\text{ mm} \times 322\text{ mm}$



PandaADCP-SC-75K-Phased-3000m

Physical property

Casing: Titanium alloy
 Standard depth rating: 3000m
 Weight in air: 62kg
 Weight in water: 44kg
 Dimensions: $\Phi 348\text{ mm} \times 322\text{ mm}$



PandaADCP-SC-75K-Phased-6000m

Physical property

Casing: Titanium alloy
 Standard depth rating: 6000m
 Weight in air: 70kg
 Weight in water: 52kg
 Dimensions: $\Phi 348\text{ mm} \times 322\text{ mm}$



PandaADCP-RIVER-600K (H-ADCP)

Acoustical property

Working Frequency: 600kHz
 Beam Configuration: 2 Horizontal beams , 1 vertical beam
 Beam angle: 20°
 Horizontal beam width: 1.4°
 Vertical beam width: 5°
 Ping Rate: 2Hz(typical)
 Number of Depth Cells: 1-255
 Velocity Accuracy: $\pm 0.3\% \pm 3\text{mm/s}$
 Velocity Resolution: 1mm/s
 Velocity Range: $\pm 5.0 \text{ m/s}$ (Default); $\pm 20.0 \text{ m/s}$ (Maximum)
 Depth Cell Dimensions(High Precision Mode): 0.5m /1m /2m /4m
 Max Profiling Range : 90m

Interface Characteristics

Communications: RS-232 or RS-422
 Power Input: 20V~50V
 Power Consumption: $\leq 10\text{W}$
 Internal Memory: 64 GB Micro SD Card
 Sensors: Water Temperature, Pressure, Tilt

PandaADCP-RM-600K-200m

Physical property

Casing: POM
 Standard depth rating: 200m
 Weight in air: 6.5kg
 Weight in water: 3kg
 Dimensions: $\Phi 300\text{mm} \times 120\text{mm}$



PandaADCP-RIVER-600K (H-ADCP)

External Dimensions

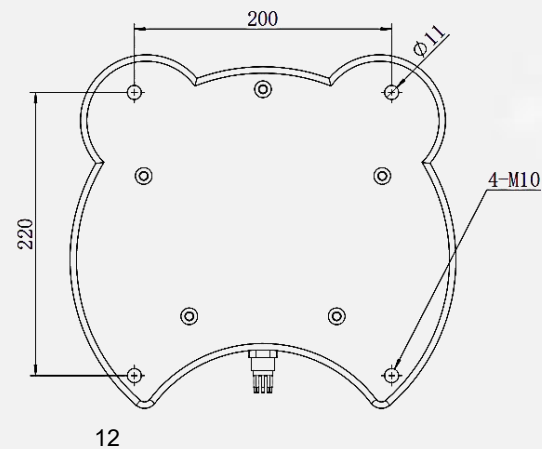



china sonar

Company: China Sonar (Hangzhou) Technology Co., Ltd.

Address: Room 181-3, bonded building, west side of Bonded Road, Hangzhou Airport Economic Zone, Xiaoshan District, Zhejiang Province

Website: <https://china-sonar.com/>

E-mail: sales@china-sonar.com Backup Email : chinasonar@gmail.com

Tel: 0571-88761989 Mobile: +8615005730266 WeChat: [oceantek15005730266](https://www.wechat.com/p/15005730266)